

A Smart Renewable Energy Solution



All-in-One Solar LED Light

Specifications

Document version: **V2.0**

May 2015

All-in-one Solar Garden / Street Light.



CE RoHS

Advantages:

- Remote control-Simple operation, change to different modes easily.
- Wireless application-Integrated solar panel, LED, lithium battery, micro-controller and other accessories into one system, simple and stylish.
- Micro-computer controlled-Combine motion sensor system, light control system and time control system perfectly, ensure whole system more energy-efficient.
- Easy installation-No trench required, no cables required, easy installation in 10 minutes.
- Solar panel angle adjustable-Rotate 360°, ensure maximum efficiency of solar energy conversion.
- Extreme light-Light efficiency reach 130lm/w, at same illumination, lower watt
- Lithium battery—Adopt lithium battery to replace traditional gel battery, longer lifetime.
- Modular design—All components are modular design and in standardized production.
- Long time working—Working continuously for 4-5 rainy days.
- Low cost—Compared with traditional solar led lights, much lower cost, easy to transport.

Features:

- Beautiful and modern appearance, simple and fashionable.
- Use of solar green energy, environment friendly, saving more.
- Low voltage driving, meet the Europe standard of CE RoHS FCC.
- No Hg, Pb or other hazardous materials, no radiation, human safety.
- IP65 grade, TVS lightning protection.
- Long lifetime of whole lamp, low maintenance costs.

Details:

Monocrystalline



- 18% photoelectric conversion efficiency
- Tempered glass over
- 20-25 years lifetime

High lumen led chip



- 45mil led chip, 150lm/w
- ≥ 75 Ra CRI
- ≥ 50000 hrs lifetime

Smart Controller



- Unique design
- 6 control modes, light control, sensor control, time control, sensor and time control, demo off mode.
- Smart control, saving more and system works

LiFePO4 battery



- High capacity
- Long lifetime, ≥ 2000 times charge & discharge
- High temperature resistance

High quality body



- Aluminum alloy, solid and firm
- Variety of installation methods
- Zinc plated, anti-rust corrosion

"Apple" shape







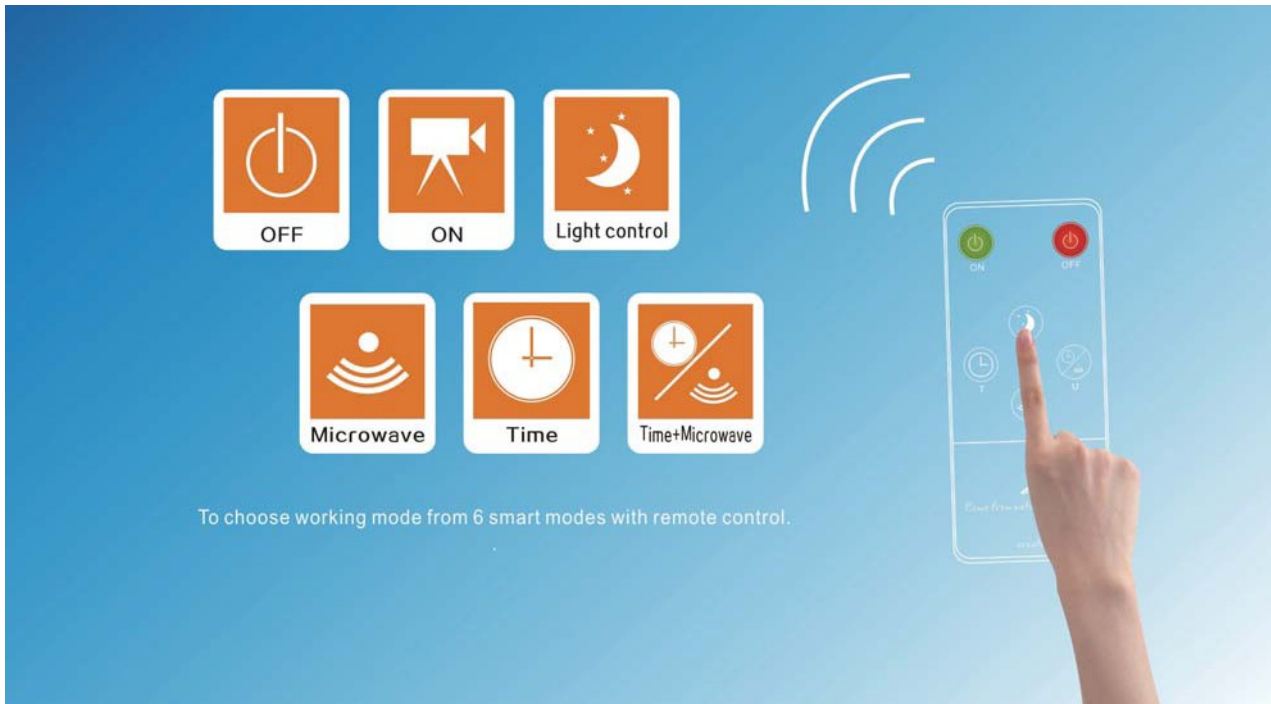

- 95% high light transmittance
- High quality PMMA, long lifetime
- Strip cover, soft lighting for eyes

Remote Control



Six working mode choices

-  **ON:** No matter day or night, light "on" when people close, light "off" after people left.
-  **OFF:** Light "off", no matter day or night.
-  **L:** At night, 100% light when motion detected, 30% light 20s after people left. In daytime, light "off".
-  **M:** At night, light "on" when people close, light "off" after people left. In daytime, light "off".
-  **T:** At night, 80% light for 2 hours, 60% light for another 2 hours, then light "off".
-  **U:** At night, 80% light for 2 hours, 60% light for another 2 hours, then turn to motion sensor, light "on" when people close, light "off" after people left.

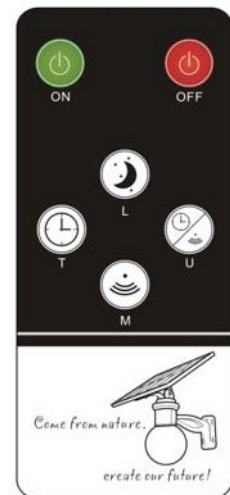

Applications:

Widely used in Park, Villa, Village, Square, Courtyard, Farm, School, Desert, Prairie, Path etc...the places where need outdoor lighting and with enough sunshine.



Easy installation in 10 minutes!

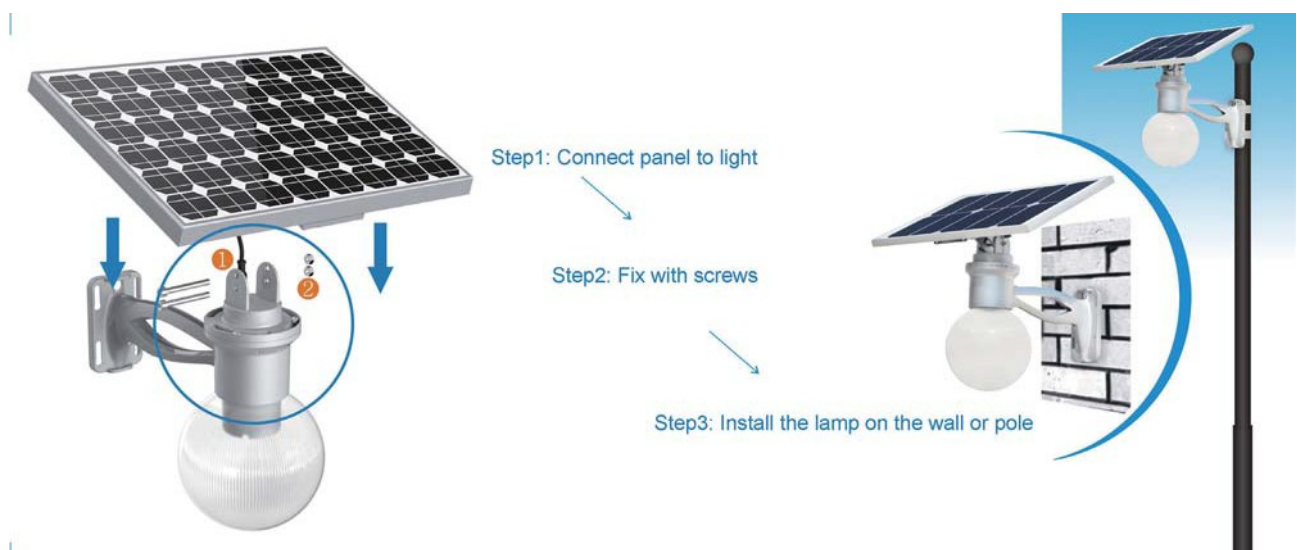

Hitechled Optoelectronics Co.,Ltd.

Office Add.: 21st F, Bldg.B, GLC Plaza, Baoming 2nd Road, Bao'an district, Shenzhen, China 518102

Tel: +86 755 33653232 Fax: +86 755 33653211 E-mail: sales@hitechled.cn [Http://www.hitechled.cn](http://www.hitechled.cn)

Solar panel angle adjustable schematic diagram:



Parameters:

Type	HT-SA-1004	HT-SA-2008
Power	4W	8W
Solar panel	12W/5.4V	25W/5.4V
Lithium battery	10AH/3.2V	20AH/3.2V
LED qty	6pcs	6pcs
Luminous flux	400-500 lm	800-900lm
LED chip	Bridgelux	
Color temperature	3000-6500K	
CRI	>75Ra	
Light control voltage	1v	
Illumination (stand by)	30%	
Sensor area	<10meters	
Lighting last	20s	
Charge time	6hours	
Discharge time	24hours	
Working temperature	-20-60°C	
Lifetime	≥50000hours	
Material	High quality aluminum alloy, die-cast aluminum	
Mounting height	2.5-4meters	
Installation spacing	5-10meter	

The data of its working time was measured at latitude 22 °, 113 ° east longitude in sunny days. The working time will be affected by the surroundings.

Hitechled Optoelectronics Co.,Ltd.

Office Add.: 21st F, Bldg.B, GLC Plaza, Baoming 2nd Road, Bao'an district, Shenzhen, China 518102

Tel: +86 755 33653232 Fax: +86 755 33653211 E-mail: sales@hitechled.cn Http://www.hitechled.cn

Instructions:

- Solar Apple light lamp, need solar power to charge battery, please select appropriate model based on local sunshine conditions.
- Please avoid solar panel be block by building, trees or other obstructions, otherwise it will reduce efficiency of solar panels working, resulting in lower efficiency of system.
- Charging temperature of Lithium battery is 0 to 55°C , the discharging temperature is -20 to 60°C , make sure that ambient temperature is in this range when used, avoid damage to lithium battery.
- Please cleaning surface of solar panels regular, such as dirt, leaves, oil, etc., ensure high photoelectric conversion efficiency.
- Cleaning snow of solar panel surface timely in winter.

List of accessories

- 304 expansion screws & spacer & nut.....4sets
- Fixed the back light pole.....1pc
- 304 hexagonal screw(M6*70) & nut.....2sets
- 304 hexagonal screw(M6*12).....3pcs
- Hexagon wrench M5.....1pc
- Open spanner M14.....1pc
- Remote control.....1pc